

Edging and Mounting Guidelines

Crizal[®]ALIZÉ[®]

Crizal[®]ALIZÉ[®]
WITH CLEAR GUARD[™]

Crizal[®] with SCOTCHGARD[®] AVANCÉ[™]

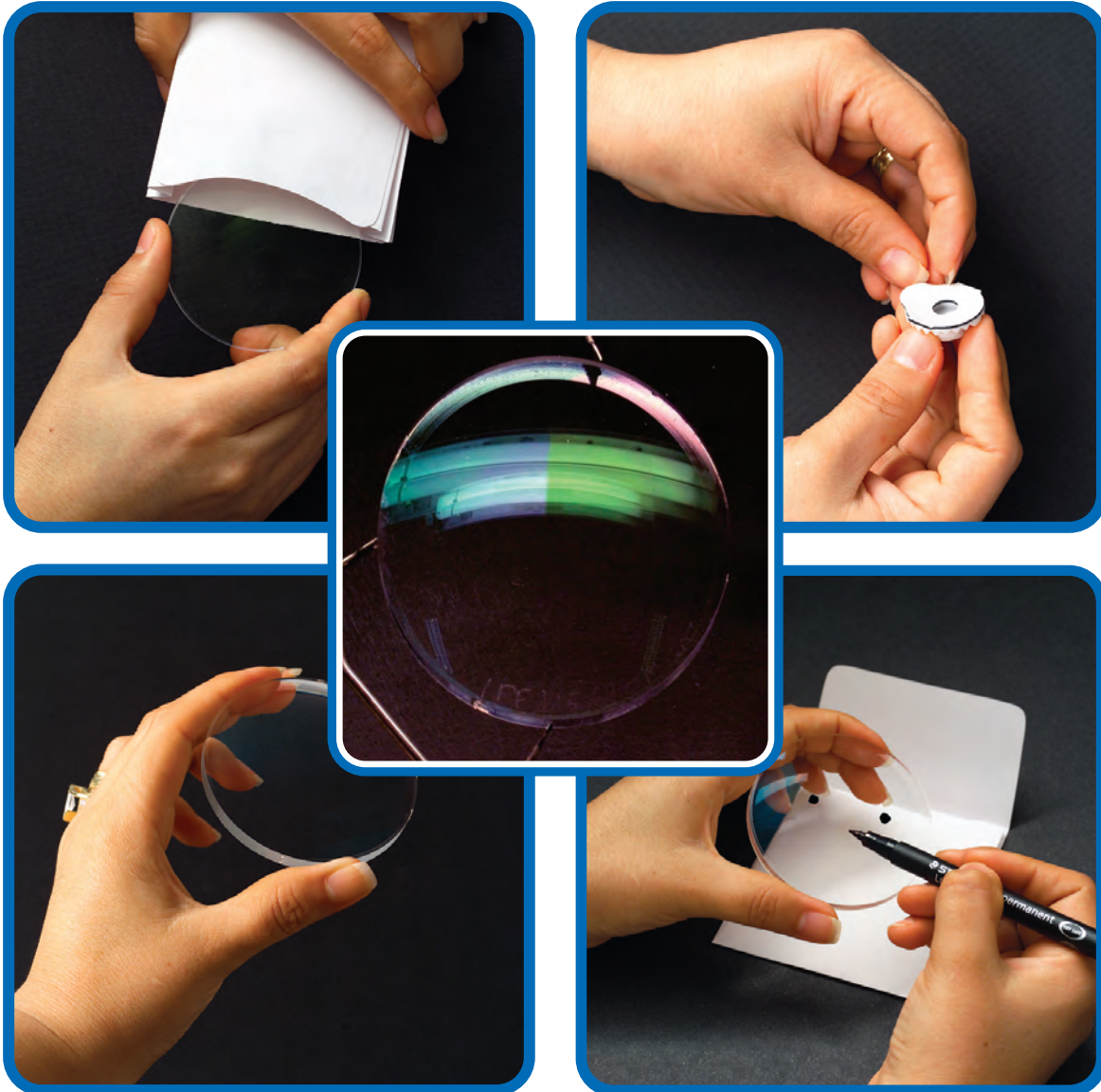

■ Upon receipt from your laboratories, the lens has a blue reflection

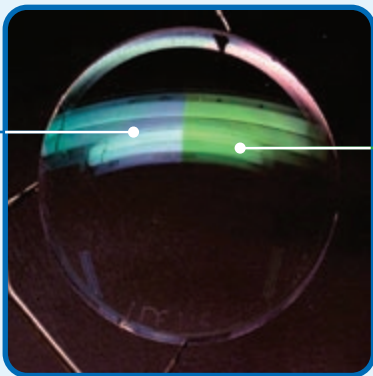

After finishing and cleaning, the lens has the green residual color associated with the Crizal lenses.

EDGING CRIZAL® LENSES

As Crizal® lens technology advances to include not only unbeatable durability, but also industry-leading super hydrophobic and oleophobic properties, Crizal® Alizé®, Crizal Alizé with Clear Guard™, and Crizal Avancé™ with Scotchgard™ Protector lenses incorporate a distinctive feature called the **Pad Control System™** to assist with the edging process.

- The distinctive feature of this lens is the temporary **Pad Control System** that assists with the edging process. This layer provides the adhesion required to block the lens for edging, grooving, drilling and retouching.
- The Pad Control System gives the lens a blue residual color. See picture for color appearance. After removing this temporary Pad Control System with a soft cloth, the lens will have the original Crizal green reflection.



Handle by edges

1 LENS HANDLING

- Perform cosmetic inspections on lenses upon receipt into Finishing. **DO NOT clean or remove the Pad Control System before lens blocking.**
- The lens must keep its Pad Control System on both lens surfaces during edging, grooving, drilling and retouching.
- Lenses should be handled by the edges only, avoiding all finger or hand contact with the lens surface.



2 LENS BLOCKING

- Ensure the block is dry and clean.
- Do not touch the block adhesive.
- Apply the adhesive to the block.
- Improper handling may cause block slippage during the edging process.

3 LENS EDGING

- Select the material option that corresponds to the lens to be edged.
- Place the blocked lens in the edger, making sure not to touch the lens surface. Begin the edging cycle.
- Once the edging cycle is completed, make sure to remove the edged lens without touching its surface.



NOTE: Failure to follow any of these guidelines may cause unexpected removal of the block during the edging process.

4 LENS MOUNTING

Verify lens fit before removing the edging block. Once removed, the edging block cannot be reapplied.

Before mounting the lens in the frame:

- Remove the blue Pad Control System from the lens surfaces with a soft cloth.
- When edging rimless lenses, it is recommended to mark the drilling points with an approved permanent marker. (Recommend Staedtler Red Lumocolor #317)

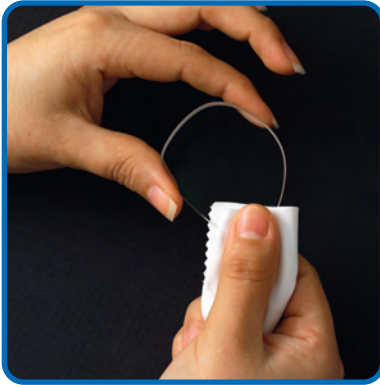

5 FINAL CLEANING

Once Again, after mounting, the Pad Control System removal and lens cleaning should be completed by using a soft cloth. Remove the Pad Control System and clean the lens by wiping both lens sides at the same time. See picture at right. Ensure that the entire Pad Control System has been removed from the lenses. This is evident by the removal of the blue reflection from the lenses.



6 COSMETIC INSPECTION

After mounting and final cleaning be sure to perform a final inspection.

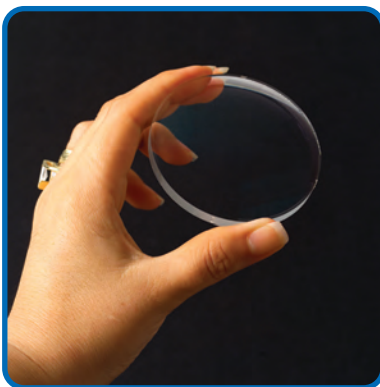

7 PROGRESSIVE LENS REMARKING

- Locate the progressive engravings
- Using the recommended marking pen (Staedtler Red Lumocolor #317) mark the center of the engraved markings.
- Apply the appropriate mask to align with the markings.
- When finished fitting, remove the mask. The ink marks can be removed by one of two ways. 1) Use a piece of tape and apply it over the ink marks. Then pull off the tape. 2) The ink can be removed by gently pushing it off with your fingernail.



NOTE: Failure to follow any of these guidelines may cause unexpected removal of the block during the edging process.